

# Reception Room

- **Good evening!** The meeting will start shortly.
- **Participants are muted** on entry.
- **Check the chat box:** Information about the hearing, including information about how to access captions and view the slides, is available there.
- **To view captions for this event:** You can view captions in Teams by clicking the More (...) button in the Teams window, then “Language and Speech,” and choose "Turn on live captions." You can also view the captions on the web at: <https://www.streamtext.net/player?event=MNDOH&start=0>.
- **If you have any technical issues,** please visit the [Microsoft support page for Teams](#) or email [Health.HRDCommunications@state.mn.us](mailto:Health.HRDCommunications@state.mn.us).

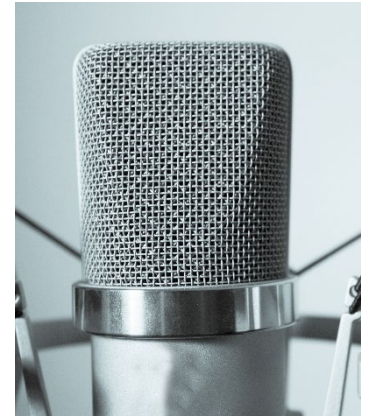



# Mahnomen Health Center Public Hearing

Transition to Rural Emergency Hospital  
April 30, 2024

PROTECTING, MAINTAINING AND IMPROVING THE HEALTH OF ALL MINNESOTANS

Your moderator for today's hearing:



**Stacy Sjogren (Show-gren)**  
Management Analysis  
and Development  
Senior Consultant

# Tennessean Warning

- **The Minnesota Department of Health is hosting this public hearing to inform the public as required by law.**
- **Your comments, questions, and image, which may be private data, may be visible during this event.** You are not required to provide this data, and there are no consequences for declining to do so.
- **The virtual presentation may be accessible to anyone** who has a business or legal right to access it. By participating, you are authorizing the data collected during this presentation to be maintained by MDH. MDH will be posting a transcript of this meeting to the website.
- **To opt out of the presentation, please exit now.**

6:05 p.m. – Introductions

6:10 p.m. – Welcome from MDH Health Regulation Division Director

6:15 p.m. – Overview

6:20 p.m. – Mahnomen Health Center presentation

6:50 p.m. – Public comments and questions

7:20 p.m. – Mahnomen Health Center closing remarks

7:25 p.m. – Conclusion

7:30 p.m. – Public hearing ends (subject to change)

# Introductions



**Maria King,**  
Health Regulation  
Division Director  
Minnesota  
Department of  
Health



**Dale Kruger,**  
MBA, LNHA  
CEO  
Mahnomen Health  
Center



**Lori Guenther,**  
MAcc  
CFO  
Mahnomen Health  
Center

# Public Hearing Overview

- **The Minnesota Department of Health serves as a neutral host** to ensure there is public discussion and engagement for any proposed closure, reduction of services or relocation of services for a hospital or hospital campus as outlined in [Minnesota Statutes Sec. 144.555](#).
- This statute gives MDH the authority to host the meeting to ensure the public has an opportunity to hear about the hospital's decision and to have their feedback heard. **MDH does not have the authority to change, delay, or prevent the proposed changes, closures or relocations.**
- The facilitator for this hearing is contracted from Minnesota Management and Budget and is **not** part of MDH.



# Mahnomen Health Center Presentation

**Mahnomen Health Center will provide information on its transition to Rural Emergency Hospital.**

- **An explanation by the hospital's representatives of the reasons for transitioning to Rural Emergency Hospital at Mahnomen Health Center.**
- **A description of the actions that Mahnomen Health Center will take to ensure that residents in the hospital's service area have continued access to the health services being modified.**



# Mahnomen Health Representatives



Dale Kruger, MBA, LNHA  
CEO



Lori Guenther, MAcc  
CFO

# Today's Agenda

- Who We Are and How We Serve the Community
- Challenges in Rural Healthcare
- Change to Service Offerings and CMS Designation
- Commitment to Community

# Mahnomen Health

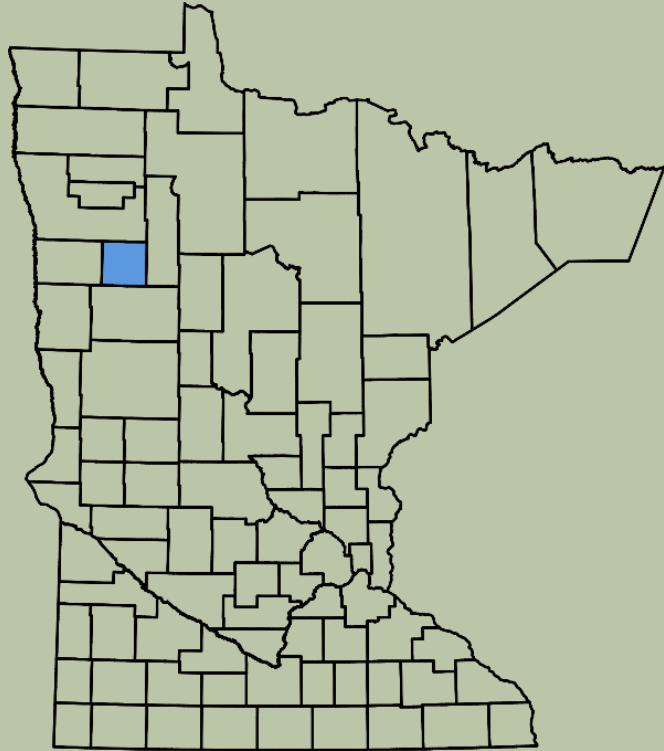

- 501(c)3 non-profit operating under a Joint Powers agreement between Mahnomen County and the City of Mahnomen
- Service area covers all of Mahnomen County and portions of Norman County
- Employs 110 individuals

## Annually

- 3,500 Emergency Department Visits
- 475 Ambulance Runs
- 35,500 Outpatient Encounters
- 92.11% Occupancy Rate in SNF



# Critical Access Hospital to Rural Emergency Hospital

- ✓ Emergency Department Services
- ✓ Observation care
- ✓ Outpatient Nursing Services
- ✓ EMS (ambulance)
- ✓ Laboratory
- ✓ X-Ray
- ✓ CT Scan
- ✓ MRI
- ✓ Dexascan
- ✓ Nuclear Medicine
- ✓ Mammography
- ✓ Physical Therapy
- ✓ Occupational Therapy
- ✓ Speech Therapy
- ✗ Inpatient
- ✗ Swing Bed

# Challenges for Critical Access Hospitals in rural communities

- Increasingly, patients are not meeting medical necessity requirements for inpatient level of care
- Costs to provide care are high and reimbursements for inpatient and swing bed services are very low when utilization of inpatient and swing bed stays are low
- Many surgeries are now done on an outpatient basis making it difficult for patients to achieve a necessary 3-day qualifying stay to be eligible for Swing Bed services

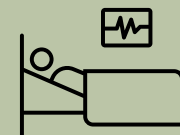
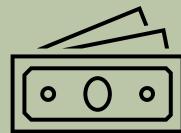

# Why we are changing

Mahnomen Health's inpatient and swing bed average daily census have been dramatically decreasing.

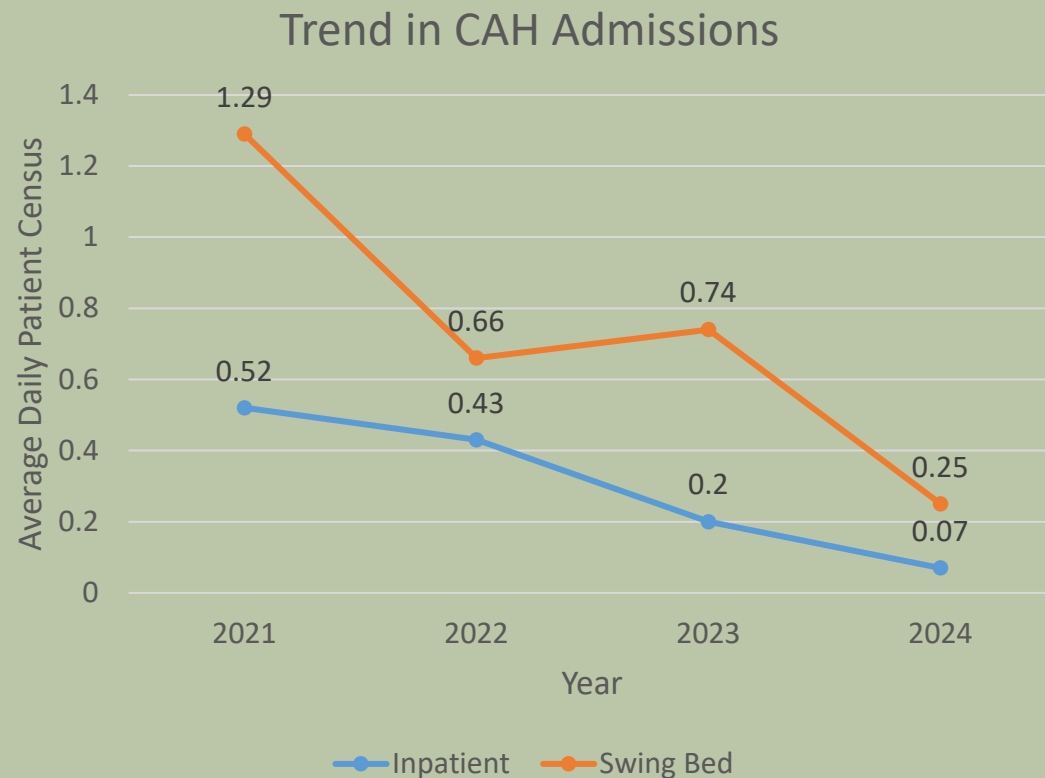

# Commitment to Keeping Healthcare Local

We remain committed to keeping healthcare local in Mahnomen County and the White Earth Nation.

We will continue to work with our partners to find placement for community members in inpatient beds as close to home as possible — the same as we do now.

We will continue to provide long term care in our Skilled Nursing Facility.

We will turn our focus to expanding our current outpatient services and work to offer more services.



- **We welcome your comments and questions.**
- **Each person will have up to three minutes to ask a question or provide public comment.**
- **Please remember that the information you are sharing is being shared virtually for a public forum.**
- **Mahnomen Health Center will have an opportunity to respond to the questions and/or comments.**

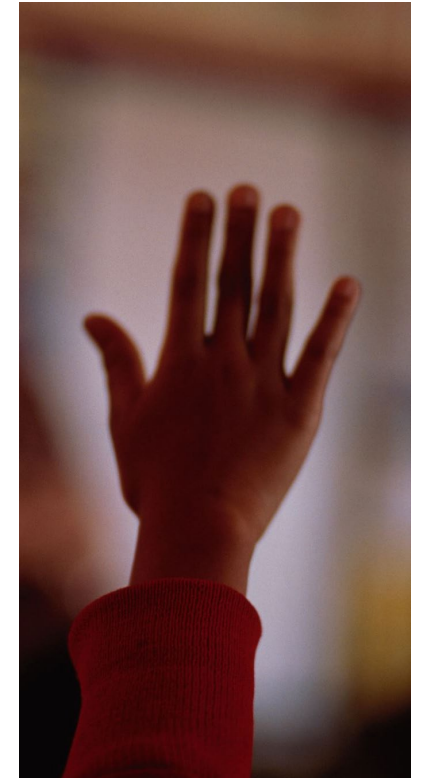



# How to Comment

**Two ways to ask a question** or provide a comment:

1. Raise your hand (outlined in red).
  2. Click the Chat bubble (circled in blue) to open the chat.
- For phone attendees, press **\*5** to raise your hand, and **\*6** to unmute/mute yourself.
  - **We will select speakers** in order and add questions from the chat throughout the public comment period.
  - **Please be respectful.** Abusive, slanderous (comments meant to discredit or malign someone) and vulgar language will not be tolerated.

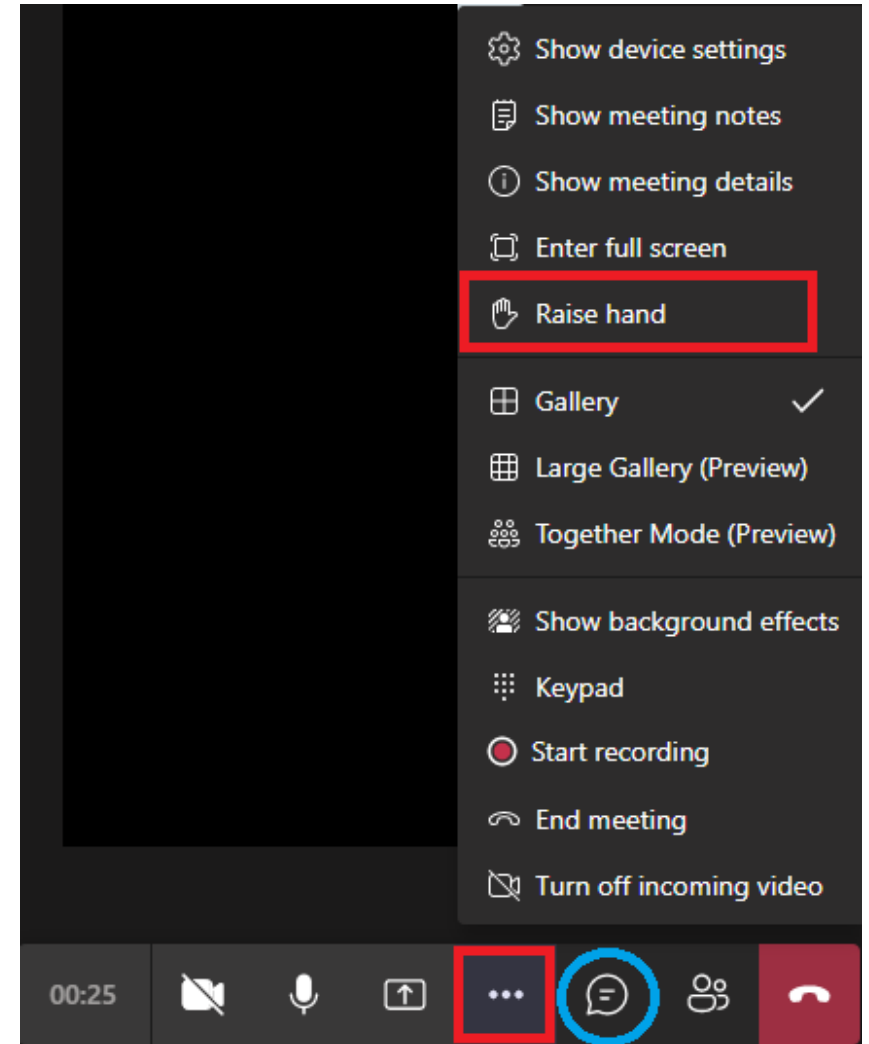

# Mahnomen Health Center Closing Remarks



**Maria King,**  
Health Regulation  
Division Director  
Minnesota  
Department of  
Health



**Dale Kruger,**  
MBA, LNHA  
CEO  
Mahnomen Health  
Center



**Lori Guenther,**  
MAcc  
CFO  
Mahnomen Health  
Center

**Last question** with 5 minutes remaining



# Conclusion

- Thank you for participating in the Mahnomen Health Center public hearing.
- The Minnesota Department of Health serves as a neutral host to ensure there is public discussion and engagement for any proposed closure, reduction of services or relocation of services for a hospital or hospital campus as outlined in [Minnesota Statutes Sec. 144.555](#).
- You may provide comments or feedback on the [hearing website](#).
  - Comments for Mahnomen Health Center will be accepted until 11:59 p.m. May 1, 2024.
- A transcript of the meeting will be available on the hearing website in 7-10 business days.



**Maria King**  
Health Regulation Division  
Director  
Minnesota Department of  
Health

# Thank you!

Health Regulation Division Federal Licensing Team

[Health.HRD-FedLCR@state.mn.us](mailto:Health.HRD-FedLCR@state.mn.us)